

**exenia**  
lighting

E2253E000

- ① Effettuare il fissaggio della montatura del sistema con idonei tasselli e viti
- ② Effectuer la fixation du systeme avec des vis et des chevilles adaptees
- ③ Secure the anchor bracket or stud to the wall, using appropriate screw anchors and screws
- ④ Befestigung des Gerates mit geeigneten Dübeln und Schrauben vornehmen
- ⑤ Efectuar el fijado de la montura del sistema con tacos y tornillos idoneos

CODICE	LAMPADA			POTENZA		
B49 52 50 --	LED	IP40	⊕ ⊖	19W	220/240V	50/60Hz

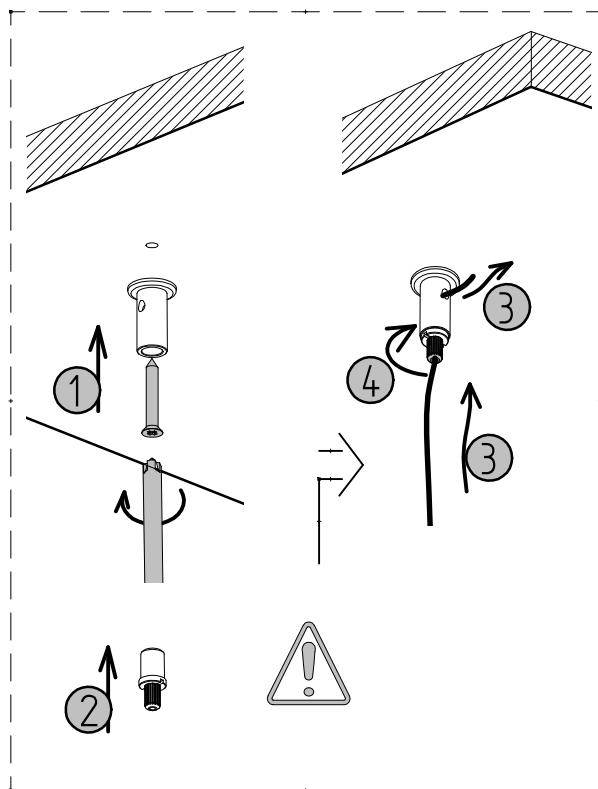
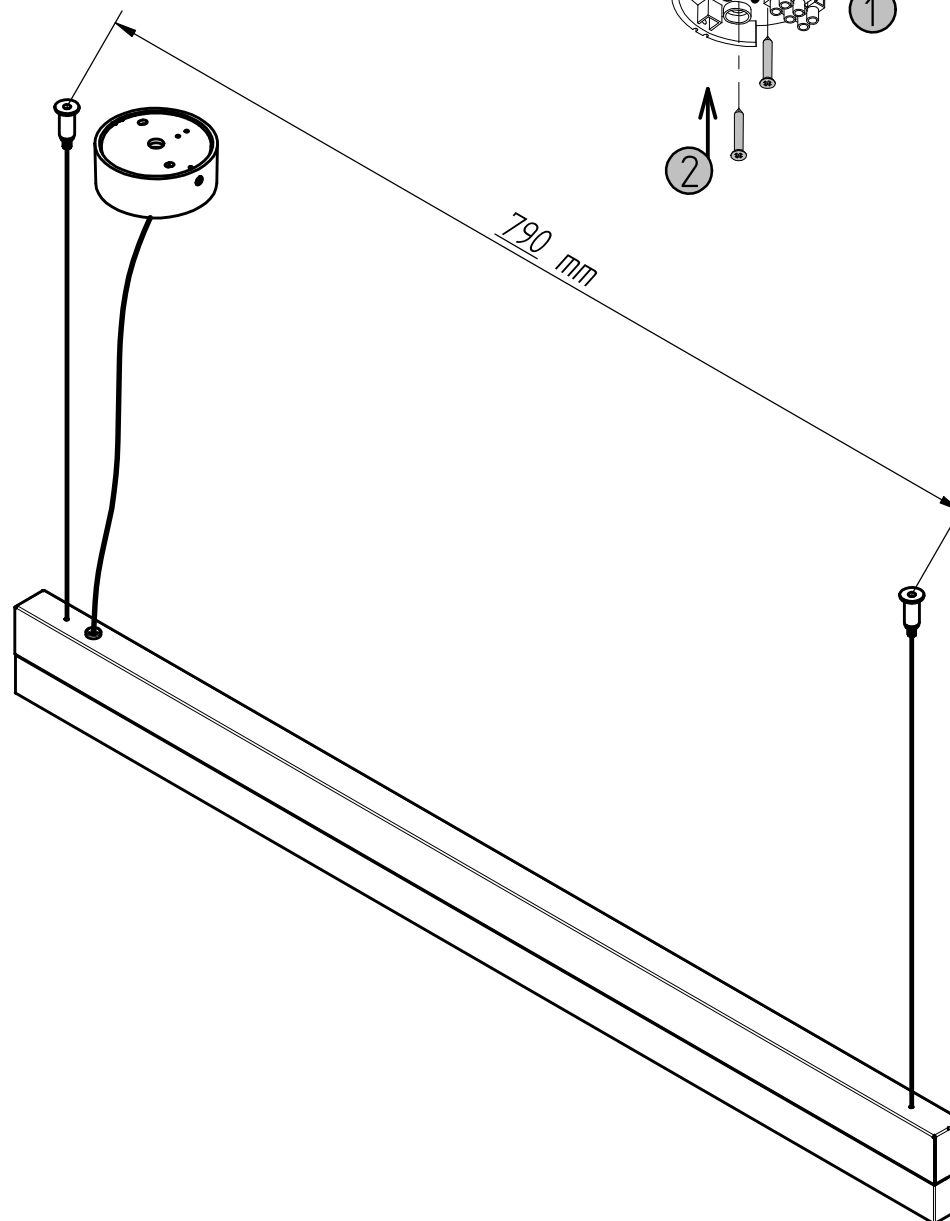
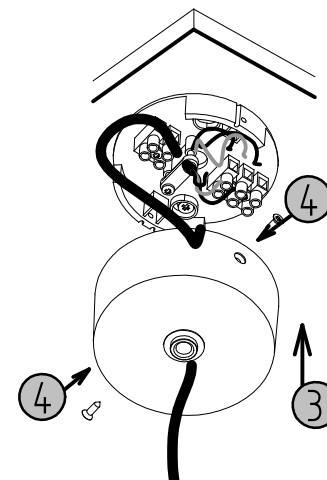
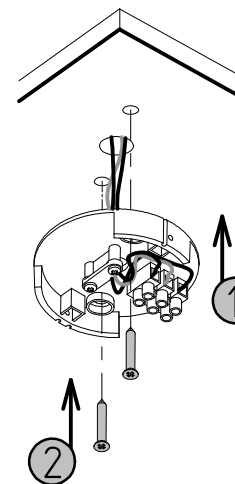

**exenia**  
lighting

E2253E000

CODICE	LAMPADA			POTENZA		
B49 60 50 --	LED	IP40	⊕ ⊖	14W	220/240V	50/60Hz
B49 61 50 --	LED	IP40	⊕ ⊖	28W	220/240V	50/60Hz
B49 62 50 --	LED	IP40	⊕ ⊖	42W	220/240V	50/60Hz

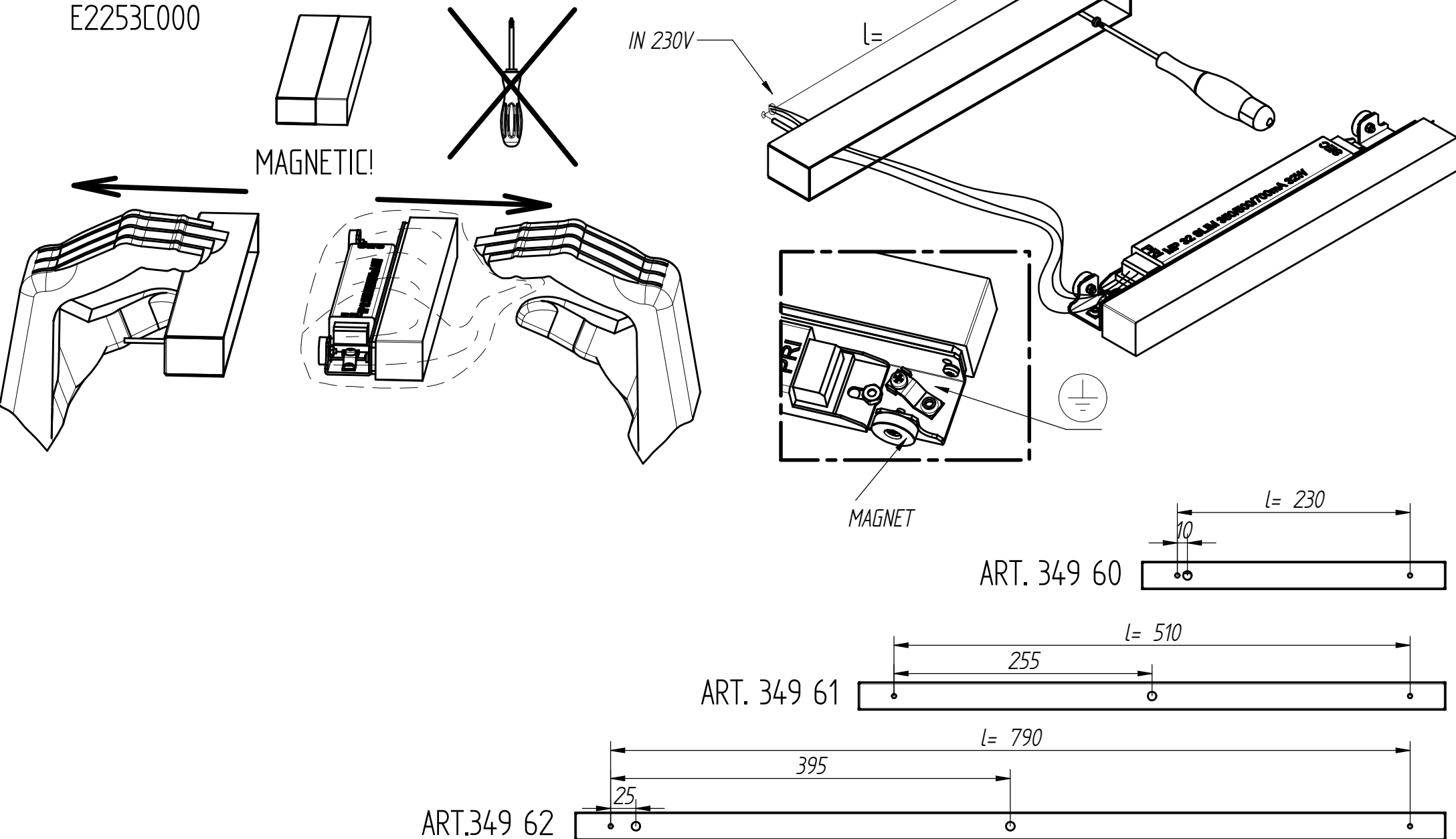

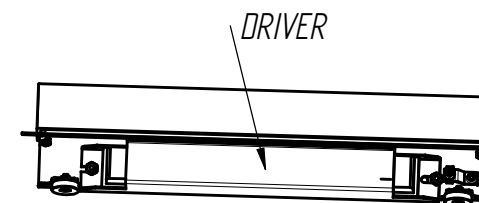
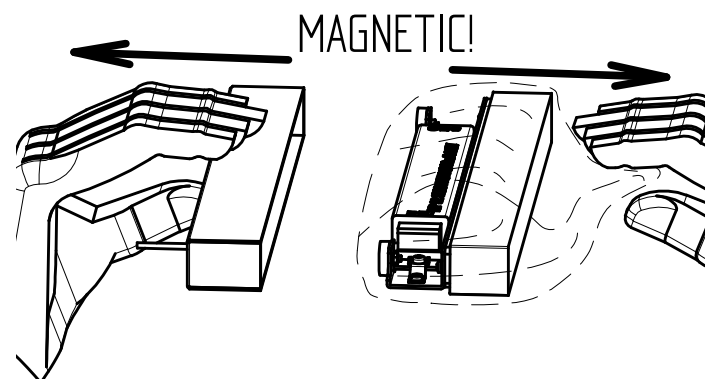
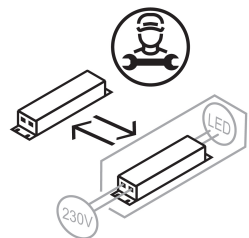
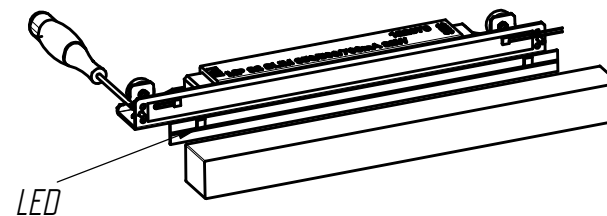
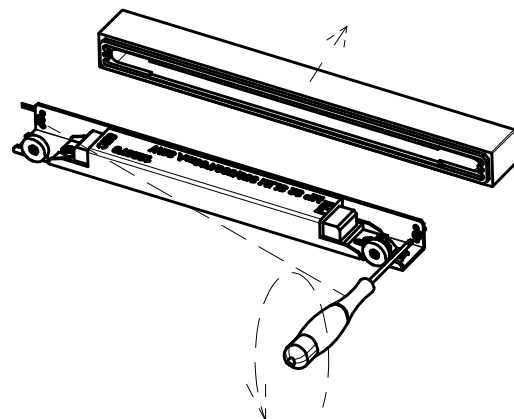
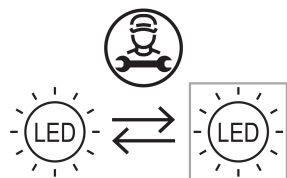

ENERGY CLASS REF.  
2700K/3000K/4000K

IT: Questo prodotto contiene una sorgente luminosa di classe di efficienza energetica D

GB: This product contains a light source of energy efficiency class D

F: Ce produit contient une source lumineuse de classe d'efficacité énergétique D

D: Dieses Produkt enthält eine Lichtquelle der Energieeffizienzklasse D

E: Este producto contiene una fuente luminosa de la clase de eficiencia energetica D