

Ref	Mode	Power	for Size	Voltage-Frequency	
372905047	on-off	MAX 150W	For. Ø=1100/1500/2000mm N.Meeting 2570x1710mm	220-240V 50/60HZ	

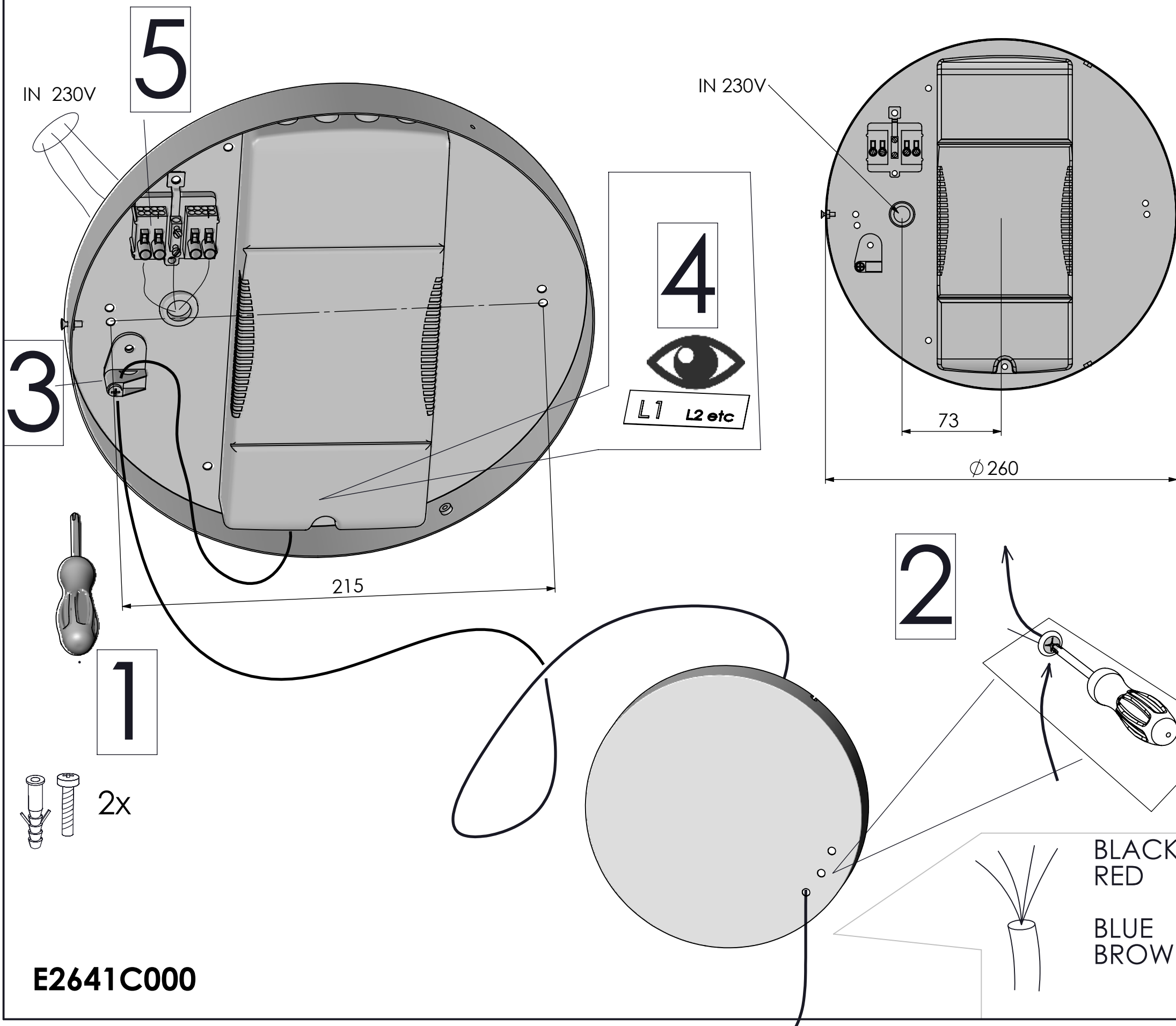

- ① ○ Effettuare il fissaggio della montatura del sistema con idonei tasselli e viti
- ② Effectuer la fixation du systeme avec des vis et des chevilles adaptees
- ③ Secure the anchor bracket or stud to the wall using appropriate screw anchors and screws
- ④ Befestigung des Gerates mit geeigneten Dübeln und Schrauben vornehmen
- ⑤ Efectuar el fijado de la montura del sistema con tacos y tonillos idoneos



BLACK "-" LINE 1  
RED "+" LINE 1  
  
BLUE "-" LINE 2  
BROWN "+" LINE 2

E2641C000

Ref	Mode	for Size	Power	
3729061--	1-10V	for Ø=1100/1500/2000 N.Meeting 2570x1710mm	MAX 150W	
3729065--	DALI		MAX 150W	
3729068--	PUSH		MAX 150W	



- ① Effettuare il fissaggio della montatura del sistema con idonei tasselli e viti
- ② Effectuer la fixation du systeme avec des vis et des chevilles adaptees
- ③ Secure the anhor bracket or stud to the wall using appropriate screw anhors and screws
- ④ Befestigung des Gerates mit geeigneten Dübeln und Schrauben varnehmen
- ⑤ Efectuar el fijado de la montura del sistema con tacos y tonillos idoneos

IN 230V ( DIMM )

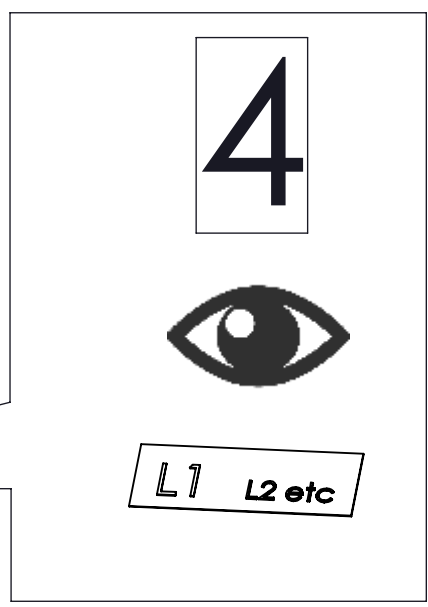
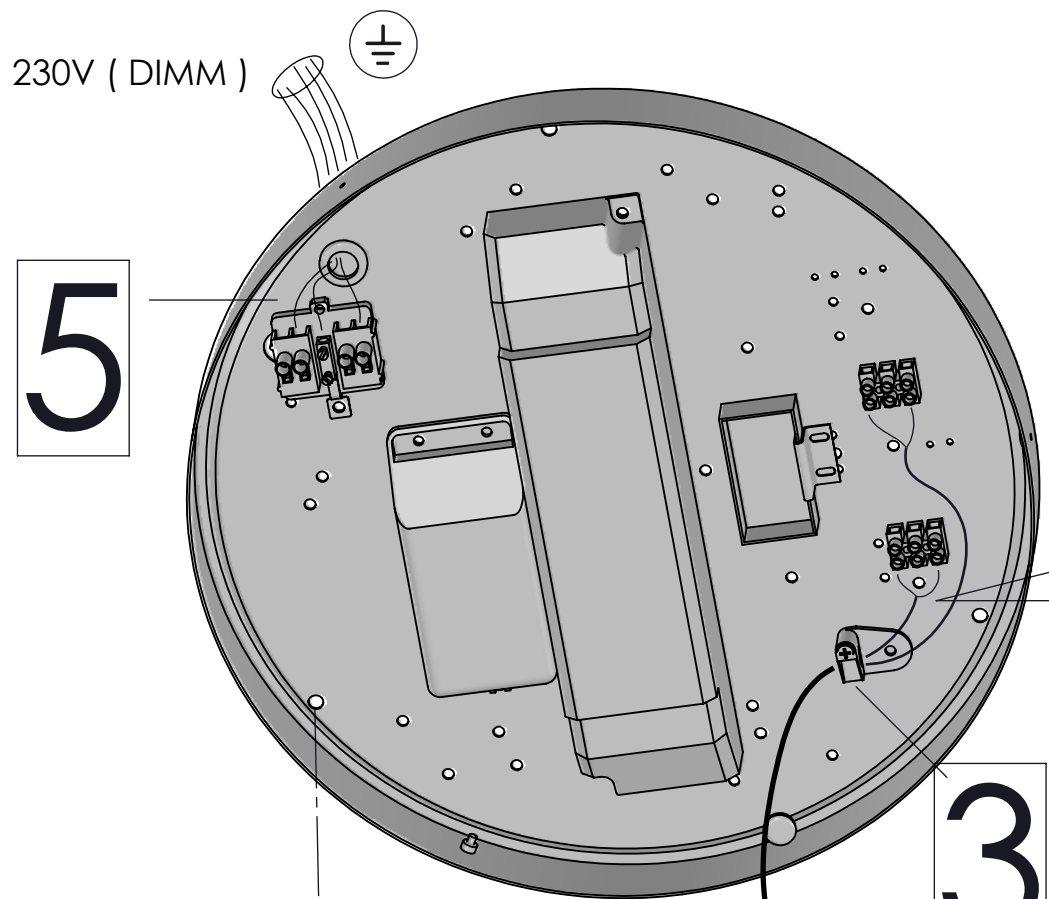

3x

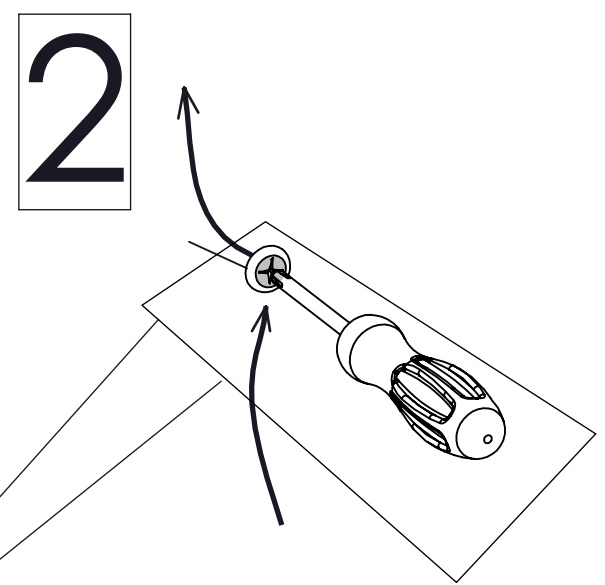
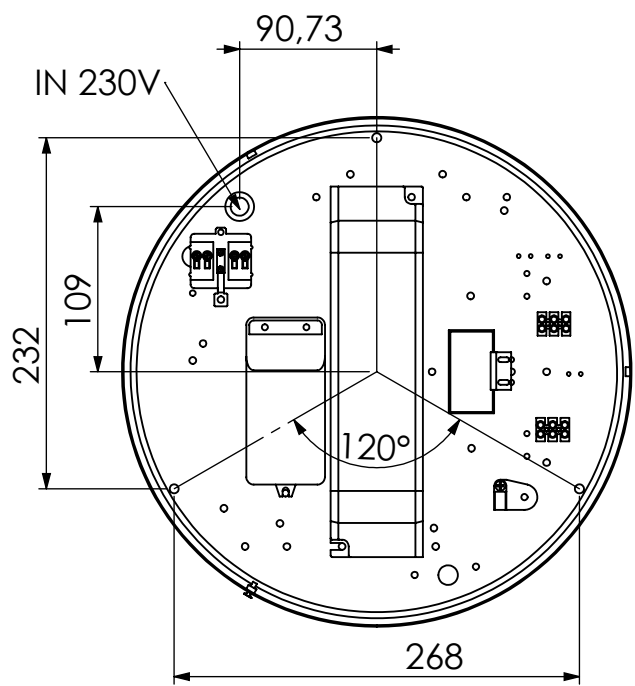
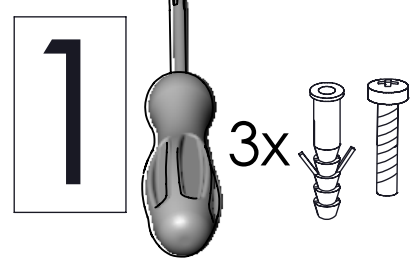
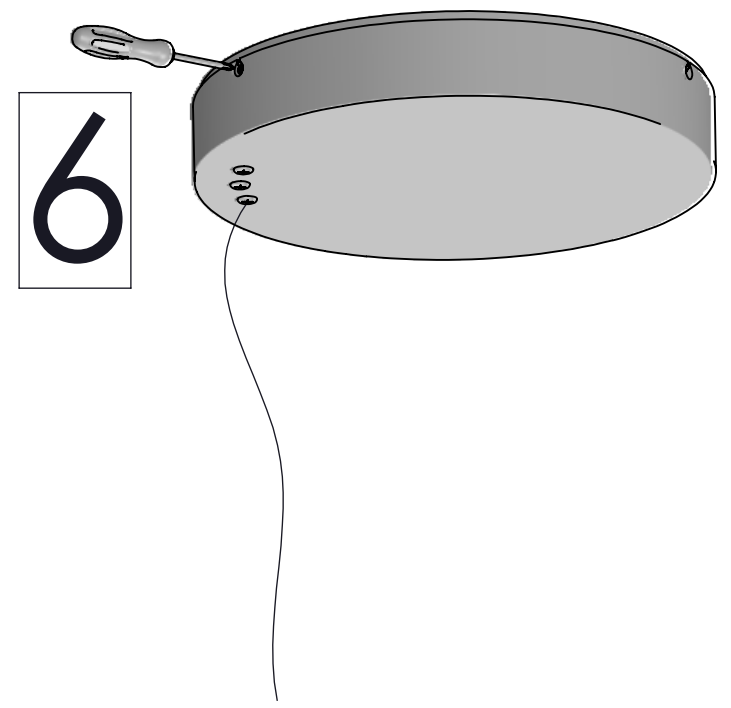

BLACK "-" LINE 1  
RED "+" LINE 1  
  
BLUE "-" LINE 2  
BROWN "+" LINE 2

Ref	Mode	Power	Voltage-Frequency	for Size	
3729150--	on-off	MAX 2x150W	220-240V 50/60HZ	for Ø=2500/3000	



- ① Effettuare il fissaggio della montatura del sistema con idonei tasselli e viti
- ② Effectuer la fixation du systeme avec des vis et des chevilles adaptees
- ③ Secure the anchor bracket or stud to the wall using appropriate screw anchors and screws
- ④ Befestigung des Gerates mit geeigneten Dübeln und Schrauben vornehmen
- ⑤ Efectuar el fijado de la montura del sistema con tacos y tonillos idoneos

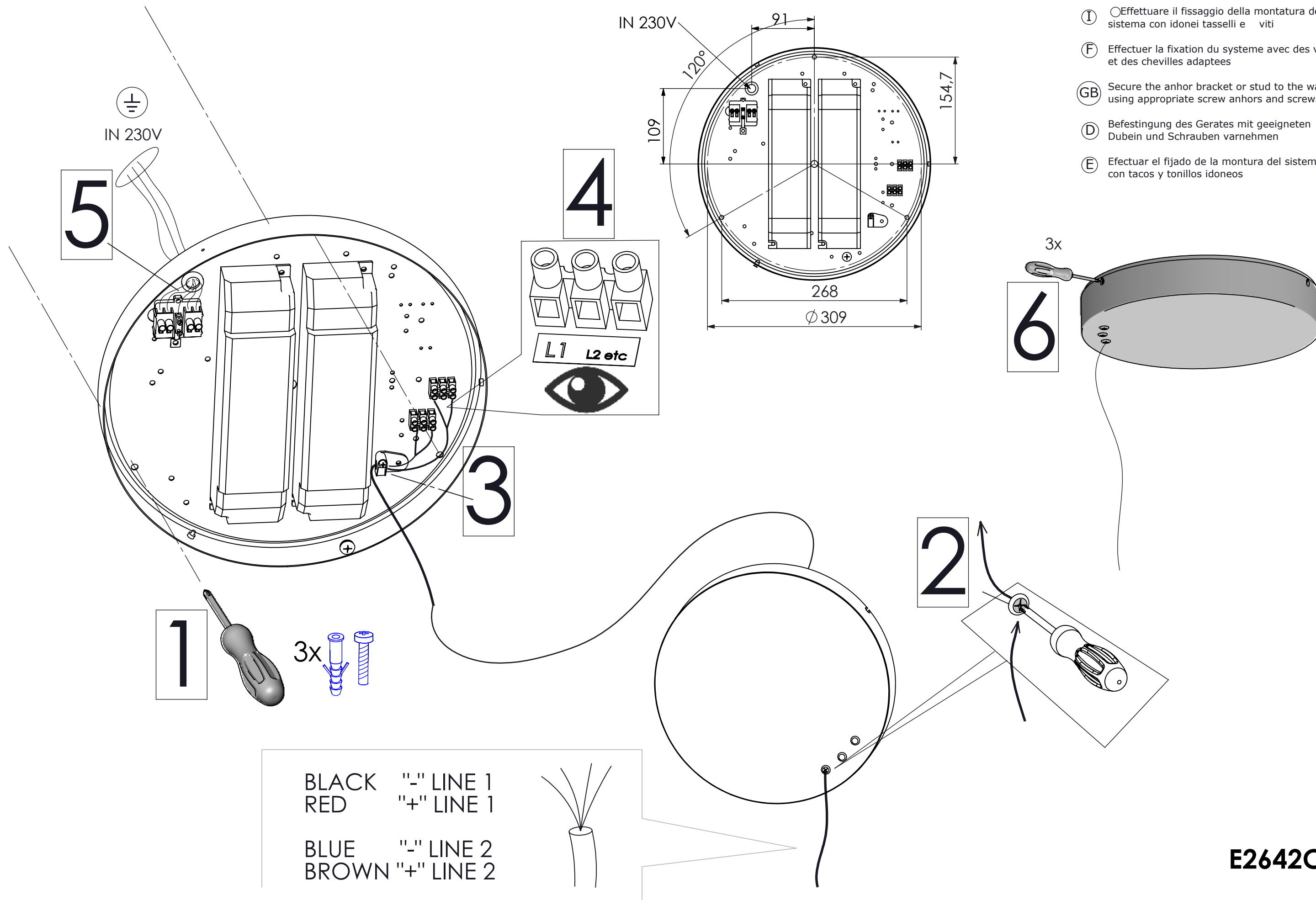

**E2642C000**

Ref	Mode	Power	Voltage-Frequency	for Size	
3729161--	1-10V	MAX 2x150W	220-240V 50/60HZ	for Ø=2500/3000	
3729165--	DALI	MAX 2x150W	220-240V 50/60HZ	for Ø=2500/3000	
3729168--	PUSH	MAX 2x150W	220-240V 50/60HZ	for Ø=2500/3000	



- I ○ Effettuare il fissaggio della montatura del sistema con idonei tasselli e viti
- F Effectuer la fixation du systeme avec des vis et des chevilles adaptees
- GB Secure the anhor bracket or stud to the wall using appropriate screw anhors and screws
- D Befestigung des Gerates mit geeigneten Dubein und Schrauben varnehmen
- E Efectuar el fijado de la montura del sistema con tacos y tonillos idoneos

  
IN 230V DIMM

5

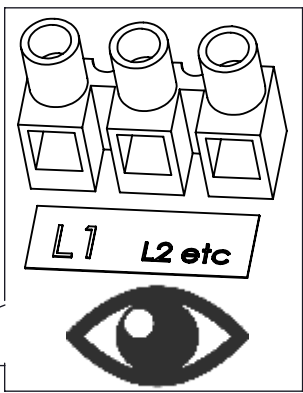
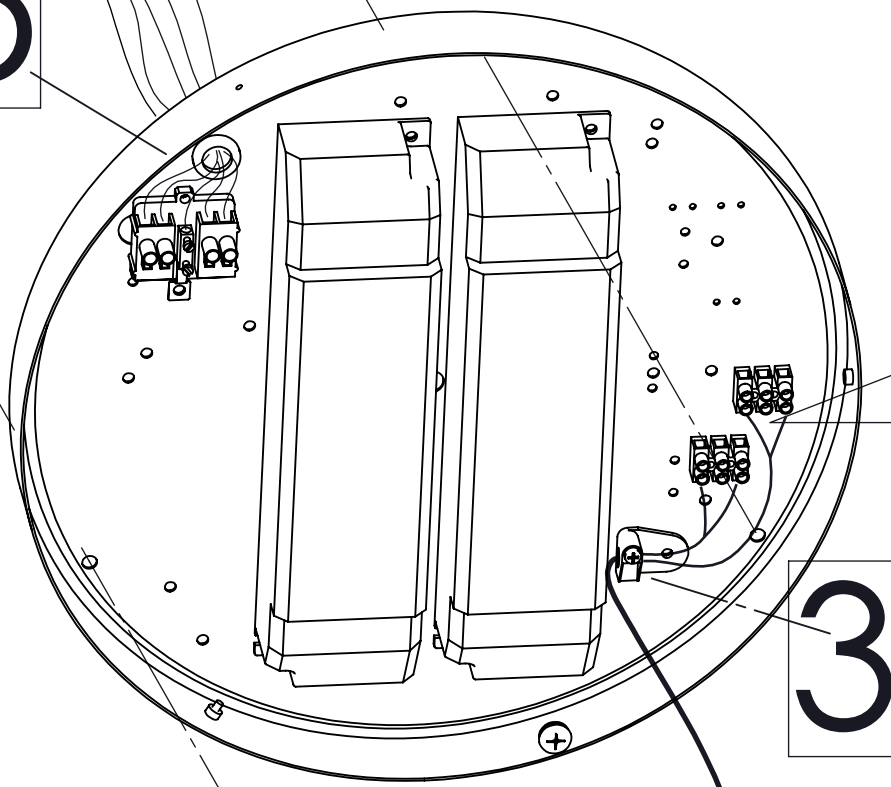

4

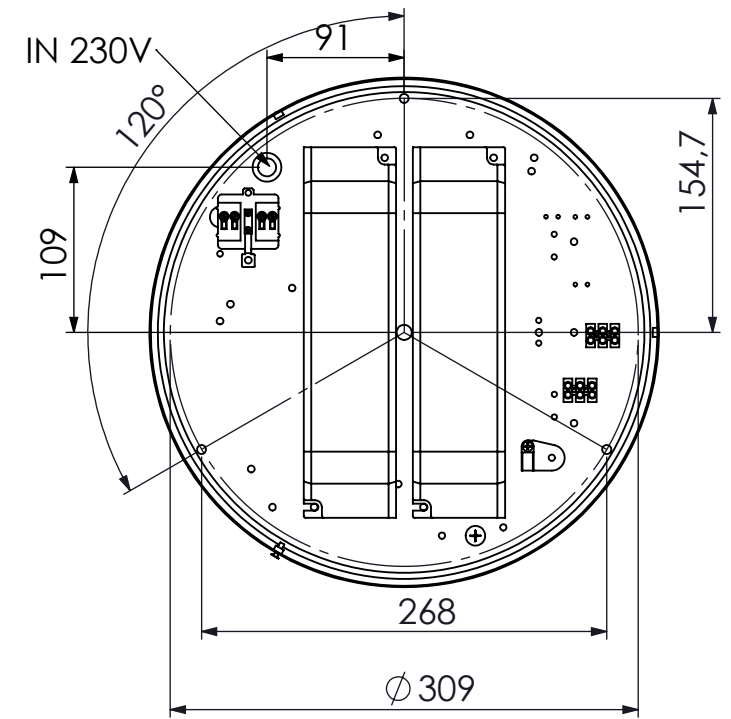

6

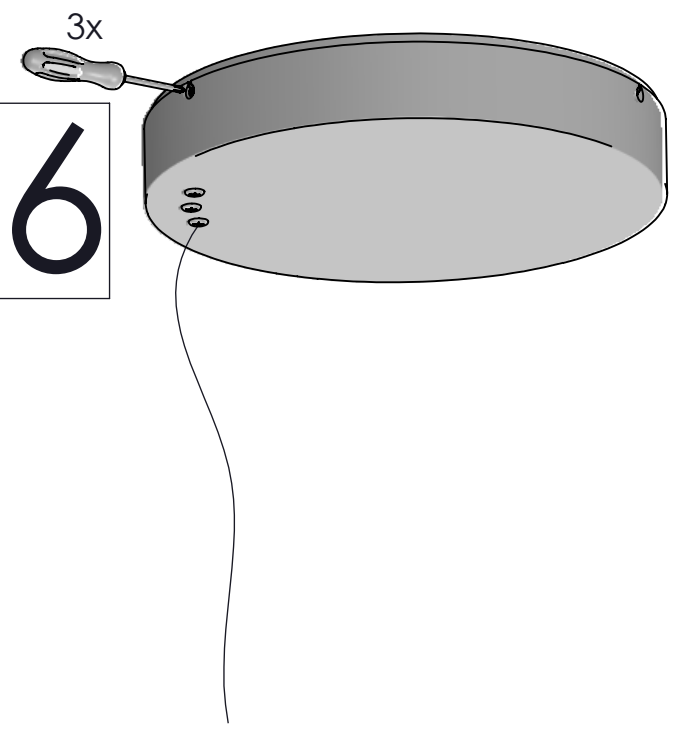

1

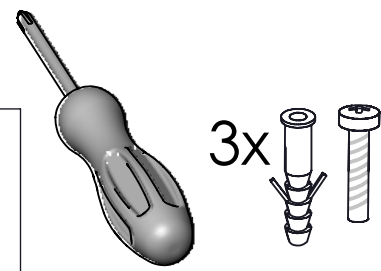

BLACK "-" LINE 1  
RED "+" LINE 1  
  
BLUE "-" LINE 2  
BROWN "+" LINE 2

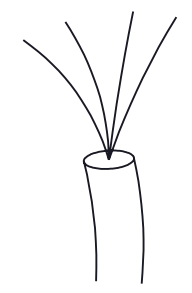

2

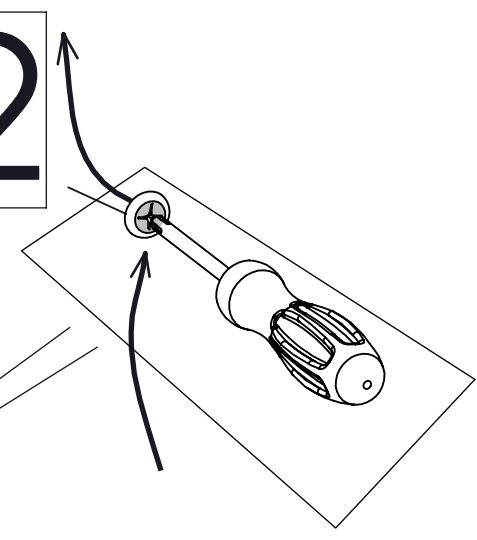

## FOR: D=2500mm

**E2480C000**

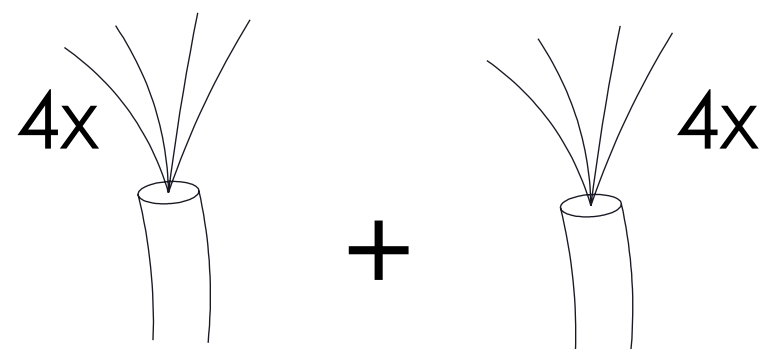

- NERO(BLACK) LINEA 1  
+ ROSSO(RED) LINEA 1

- BLU(BLUE) LINEA2  
+ MARRONE(BROWN) LINEA2

- NERO(BLACK) LINEA1  
+ ROSSO(RED) LINEA1

- BLU(BLUE) LINEA2  
+ MARRONE(BROWN) LINEA2

## FOR: D=2000mm

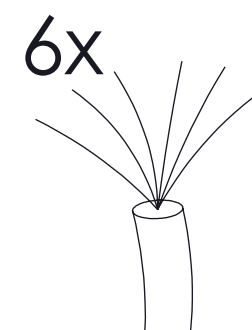

- NERO(BLACK) LINEA 1  
+ ROSSO(RED) LINEA 1

- BLU(BLUE) LINEA2  
+ MARRONE(BROWN) LINEA2

+ BIANCO(WHITE) LINEA3  
- TRASPARENTE(TRANSPARENT)  
LINEA3

## FOR: D=3000mm

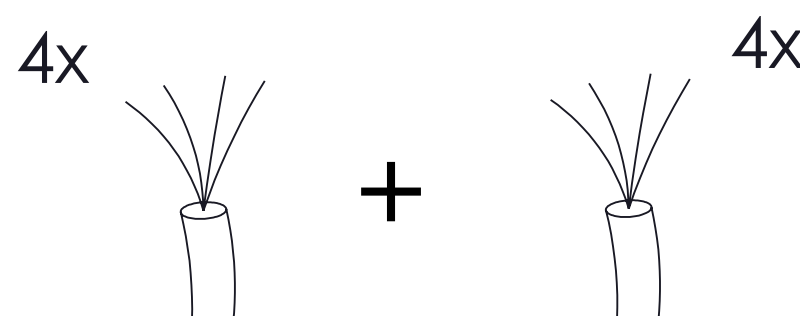

- NERO(BLACK) LINEA1  
+ ROSSO(RED) LINEA1

- BLU(BLUE) LINEA2  
+ MARRONE(BROWN) LINEA2

- NERO(BLACK) LINEA3  
+ ROSSO(RED) LINEA3

- BLU(BLUE) LINEA4  
+ MARRONE(BROWN) LINEA4



# exenia E2643C000

© brand of lumenpulse



- I Effettuare il fissaggio della montatura del sistema con idonei tasselli e viti
- F Effectuer la fixation du systeme avec des vis et des chevilles adaptees
- GB Secure the anhor bracket or stud to the wall using appropriate screw anhors and screws
- D Befestigung des Gerates mit geeigneten Dubein und Schrauben varnehmen
- E Efectuar el fijado de la montura del sistema con tacos y tonillos idoneos



IN 230V

5

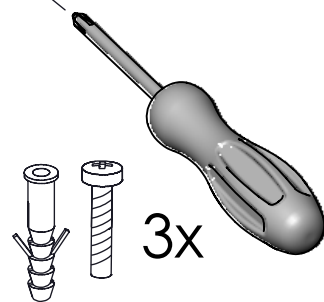
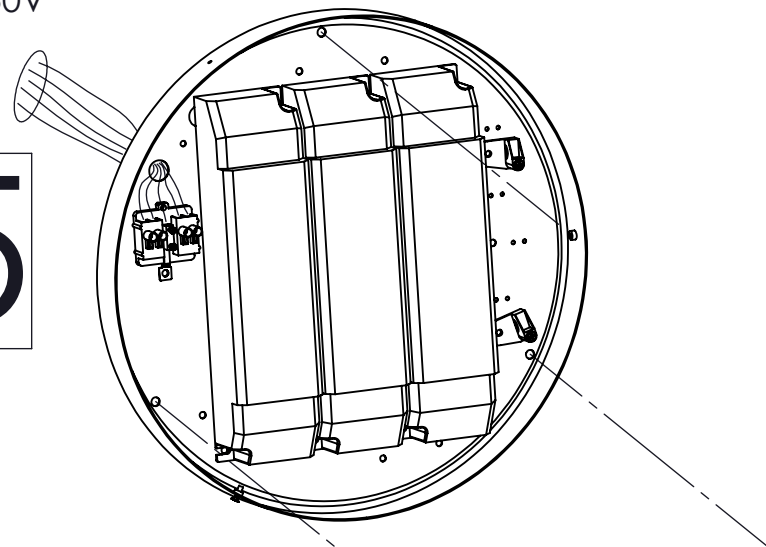

1

Ref	Mode	Power	Voltage-Frequency	
3729250--	on-off	MAX 3x150W	220-240V 50/60HZ	
3729261--	1-10V	MAX 3x150W	220-240V 50/60HZ	
3729265--	DALI	MAX 3x150W	220-240V 50/60HZ	
3729268--	PUSH	MAX 3x150W	220-240V 50/60HZ	

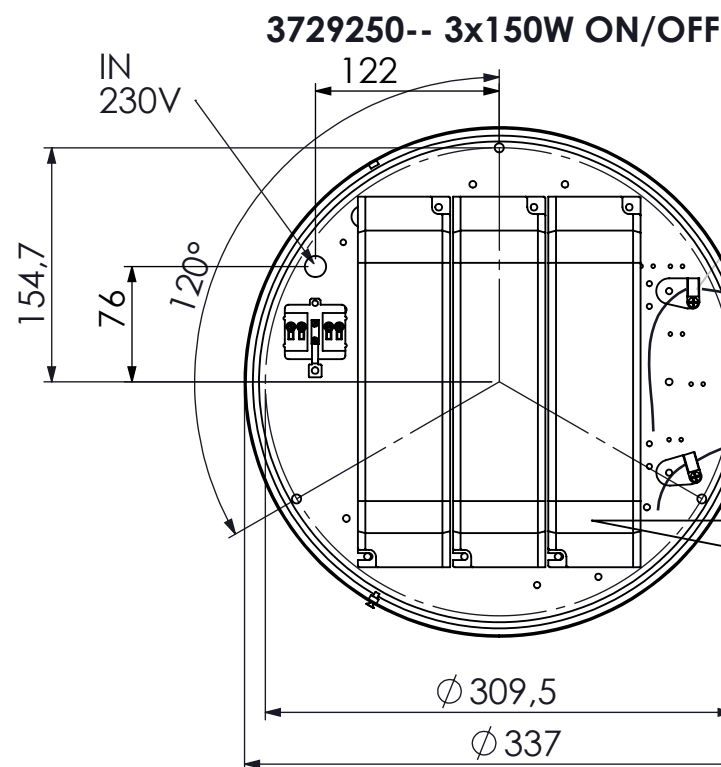

3

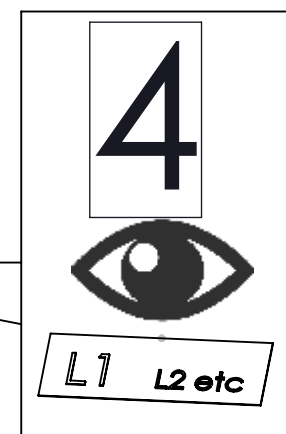

IN 230V (DIMM)

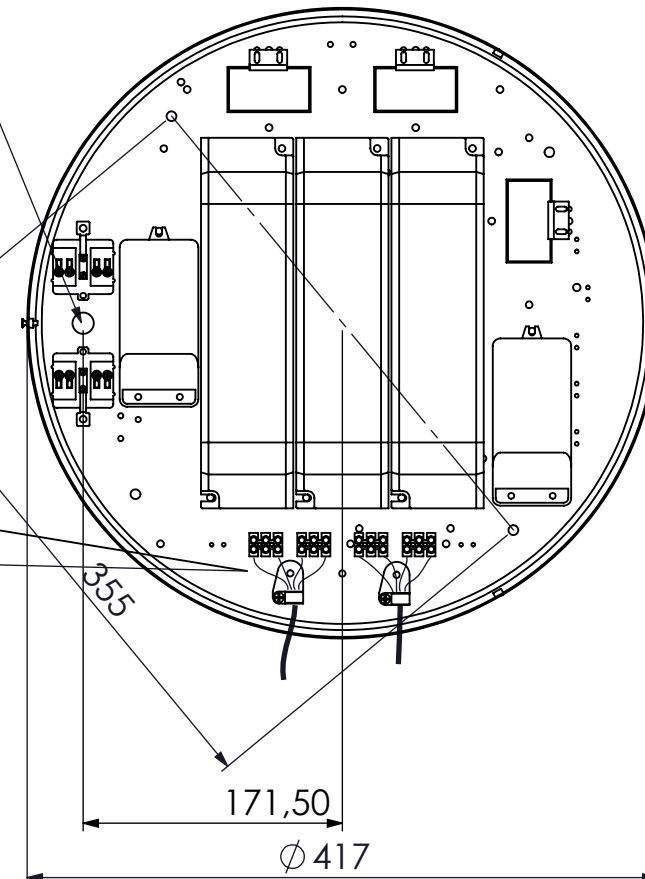

3729265-- 3x150W DALI  
3729261-- 3x150W 1-10V  
3729268-- 3x150W PUSH

2

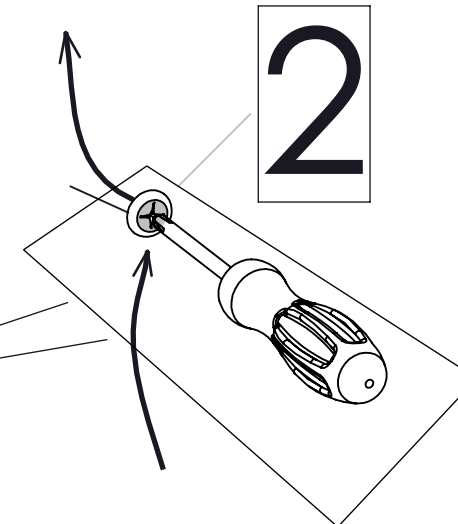

BLACK "-" LINE 1  
RED "+" LINE 1  
  
BLUE "-" LINE 2  
BROWN "+" LINE 2

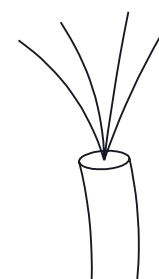
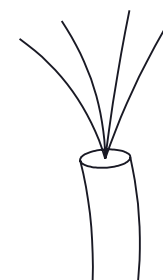

BLACK "-" LINE 1  
RED "+" LINE 1  
  
BLUE "-" LINE 2  
BROWN "+" LINE 2

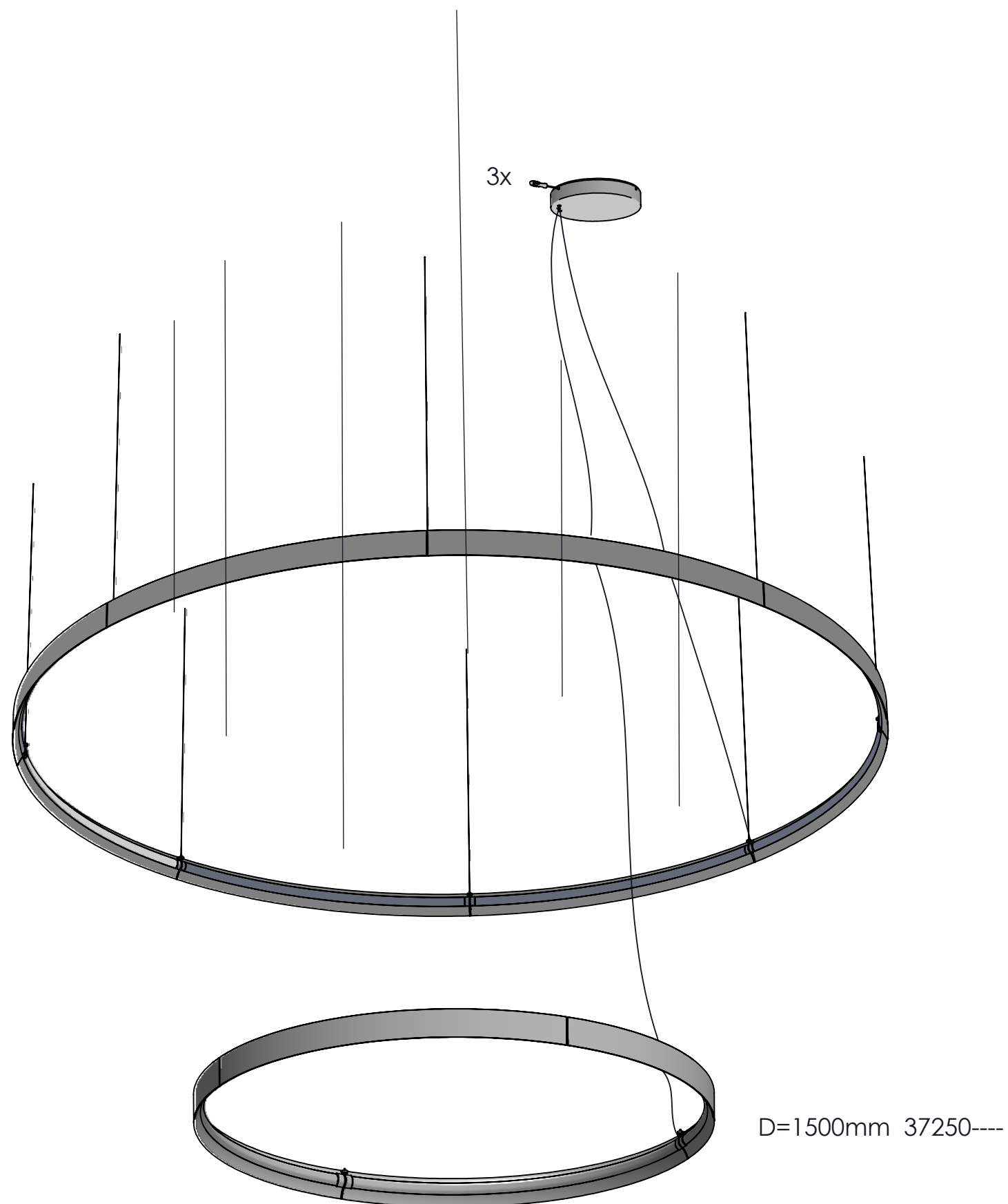

- ① Effettuare il fissaggio della montatura del sistema con idonei tasselli e viti
- ② Effectuer la fixation du systeme avec des vis et des chevilles adaptees
- ③ GB Secure the anchor bracket or stud to the wall, using appropriate screw anchors and screws
- ④ Befestigung des Gerates mit geeigneten Dübeln und Schrauben varnehmen
- ⑤ Efectuar el fijado de la montura del sistema con tacos y tonillos idoneos

